



### Whistler View

The Whistler View offers upscale living with minimal square footage. Strategically folded around a private courtyard, its distinctive lines enhance the home's unique architecture. The full-service outdoor kitchen features a double island, grill, prep sink, and rustic pergola. This mountain ranch also boasts strategically-placed transoms and high-performance windows to maximize natural light, a double-sided fireplace to connect indoor and outdoor spaces, a secluded master suite, two bedrooms with a shared bath, and plenty of storage space, including a service counter in the kitchen that can be a useful message center and charging station for today's must-have personal electronics.

Our National Design & Build Services include architectural design, construction and interior design and decor. Log on to [www.wisconsinloghomes.com](http://www.wisconsinloghomes.com) for videos and custom floor plans.

- Bedrooms:** 3
- Baths:** 2 1/2
- Square Footage:** 2,460
- Package Price:** Call for prices

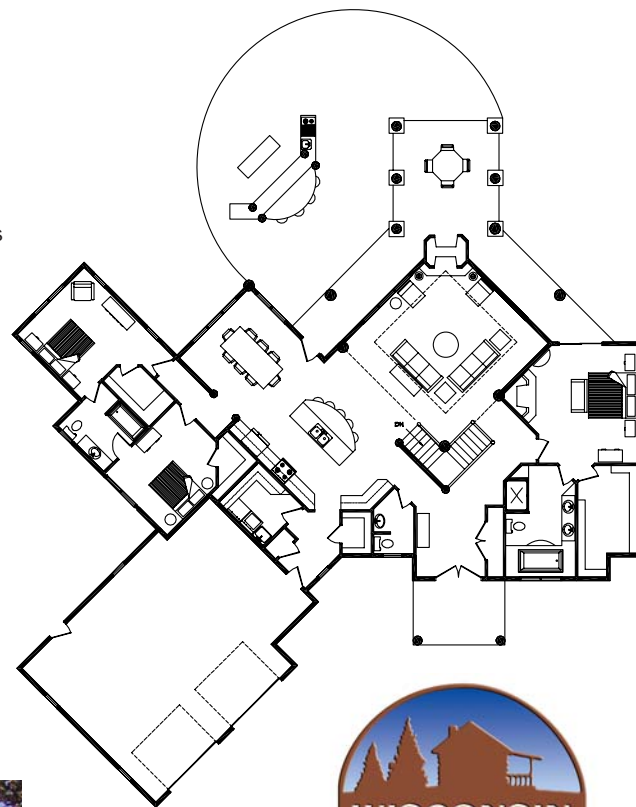

Taking You Home, Naturally.

Wisconsin Log Homes  
 2390 Pamperin Road • Dept. 70  
 Green Bay WI 54313  
 800-844-7970  
 fax: 920-434-2140  
 e-mail: [info@wisconsinloghomes.com](mailto:info@wisconsinloghomes.com)  
[www.wisconsinloghomes.com](http://www.wisconsinloghomes.com)

Circle 123 on Reader Service Card for free information