

## Glacier Falls



MODEL: Glacier Falls

FIRST FLOOR: 4,225 SECOND FLOOR: 2,811 SQUARE FOOTAGE: 7,036

*Timeless elegance, refined performance.* Designed for luxurious living both indoors and out, the Glacier Falls features a dramatic first-impression with the foyer open to the great room's massive glass wall and hand-hewn log accents. Marvelously designed and elegantly appointed, the lush living space features a gourmet kitchen, romantic first-floor master suite with fireplace nook and spa-like bath, main floor office and laundry, two bedrooms and bonus room upstairs, and plenty of loft space for family games or quiet reading. Relax in the extravagant patio featuring an outdoor entertaining area equipped with a fireplace, cocktail bar, and stove. Our Design Build Solution combines architectural design, construction and interior design & décor. Log on to [www.wisconsinloghomes.com](http://www.wisconsinloghomes.com) for video and custom floor plans.

First Floor

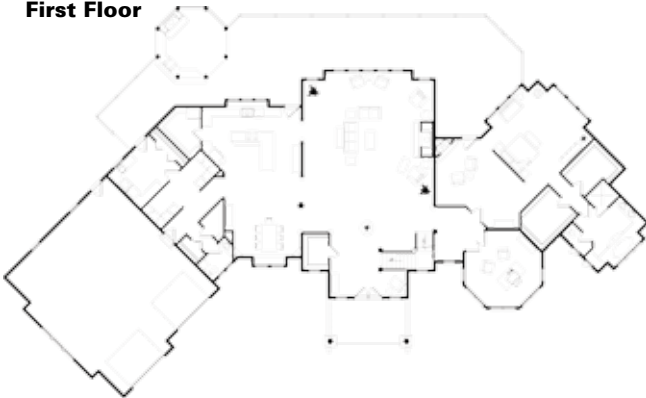

Second Floor



Hybrid Log & Timber  
Custom Architectural Design  
Interior Design Service  
Construction



Taking You Home, Naturally.

2390 Pamperin Road  
Green Bay, WI 54307-1005  
800-844-7974  
Fax: 920-434-2140  
[info@wisconsinloghomes.com](mailto:info@wisconsinloghomes.com)  
[www.wisconsinloghomes.com](http://www.wisconsinloghomes.com)