

Floor Plans



ALPINE MEADOW II - VERSION V

5,466 square feet | 6 bedrooms | 3.5 baths

Because this versatile design easily fulfills various lifestyle requirements, the Alpine Meadow II is often selected as a starting concept during the custom design process. Log onto our website to view floor plan details and additional versions of this popular design.

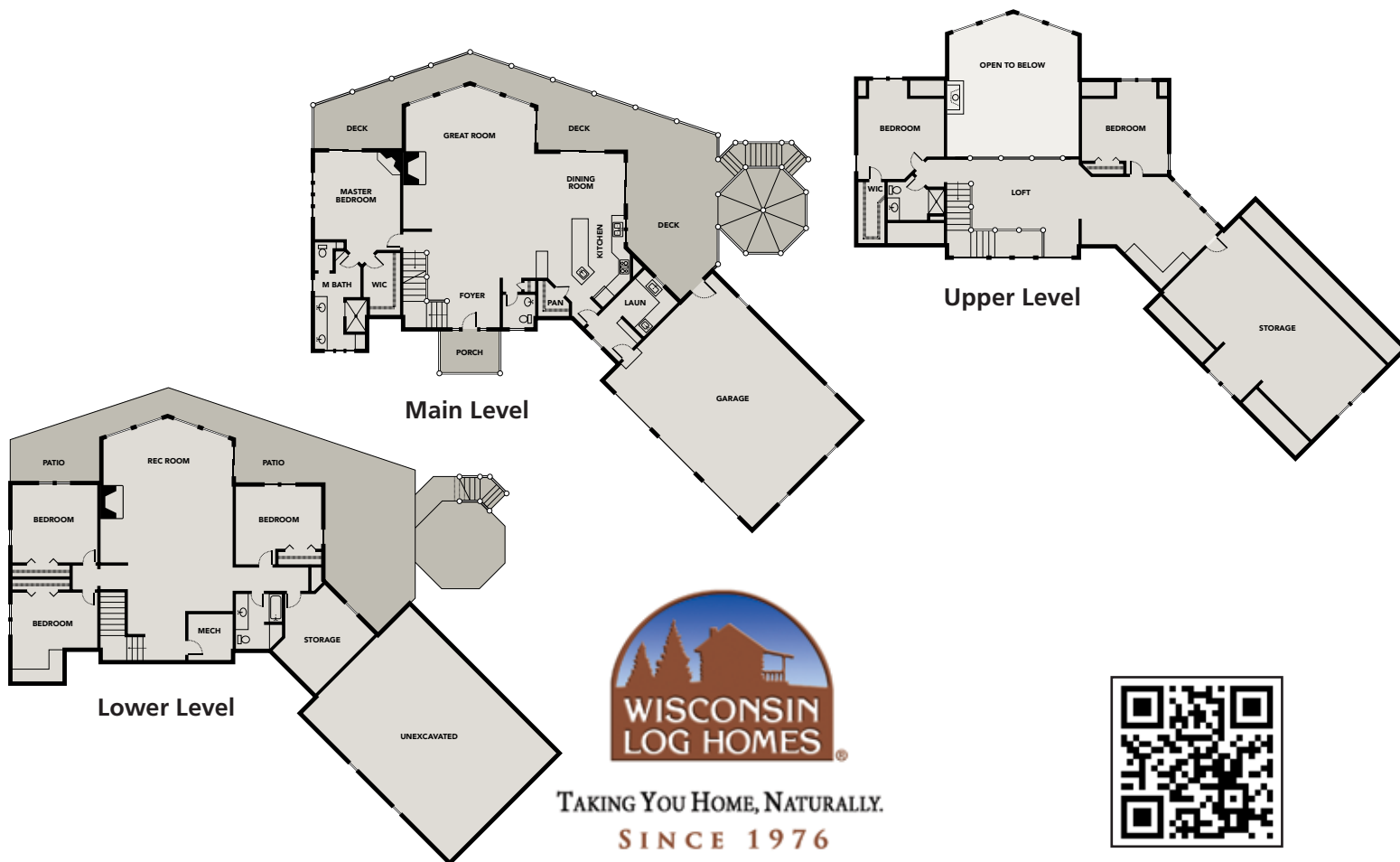

2390 Pamperin Rd., Green Bay, WI 54313

800-844-7972 *web* www.wisconsinloghomes.com *email* info@wisconsinloghomes.com

Circle 030 on Free Information Card